

**Projector Ceiling Lift**

Model: PLCV5.4HD+XD500  
 Max Projection Dimensions: 580 x Adjustable x 707mm  
 Max Load: 45kg (Projector & Cover)  
 Standard Lifting Distance: 1000mm  
 Lift Weight: ~ 44kg  
 Cable Management: Yes  
 Standard Color: Powder Coating in RAL9005 black buff

**Optional**

Upper Support Frame  
 Other RAL Colors for metallic parts  
 RF Remote Control set with circular dry contacts control option  
 RS232 external control box

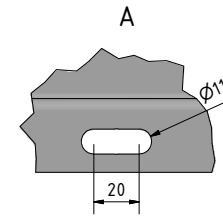
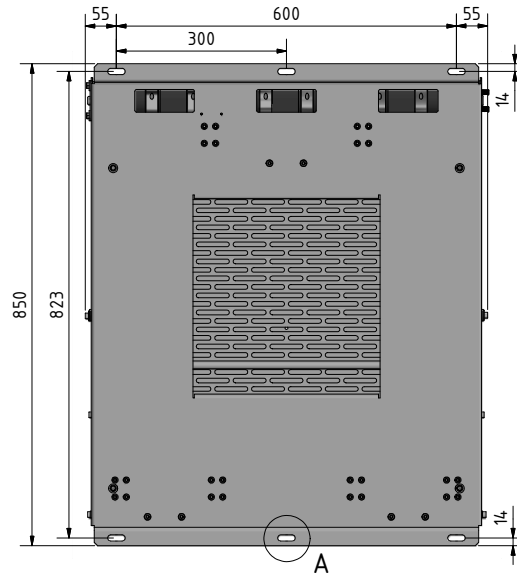
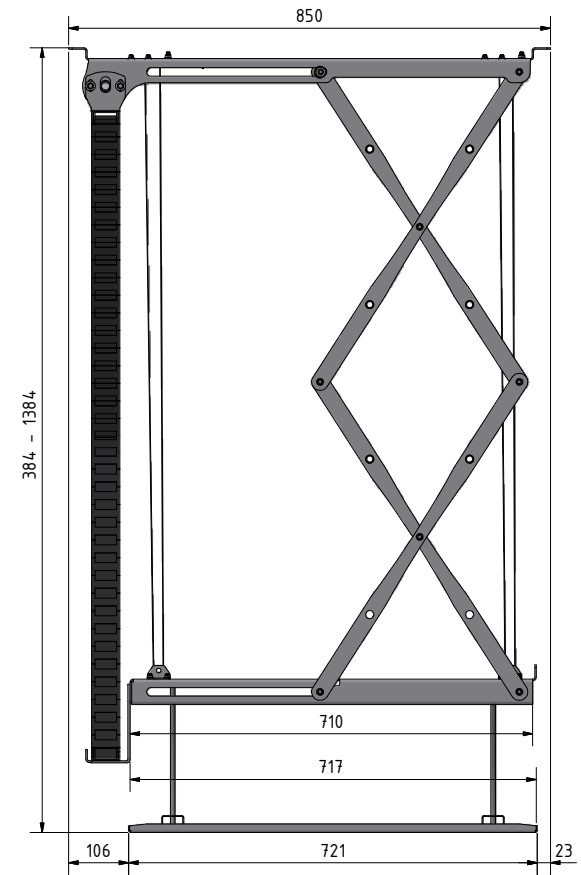
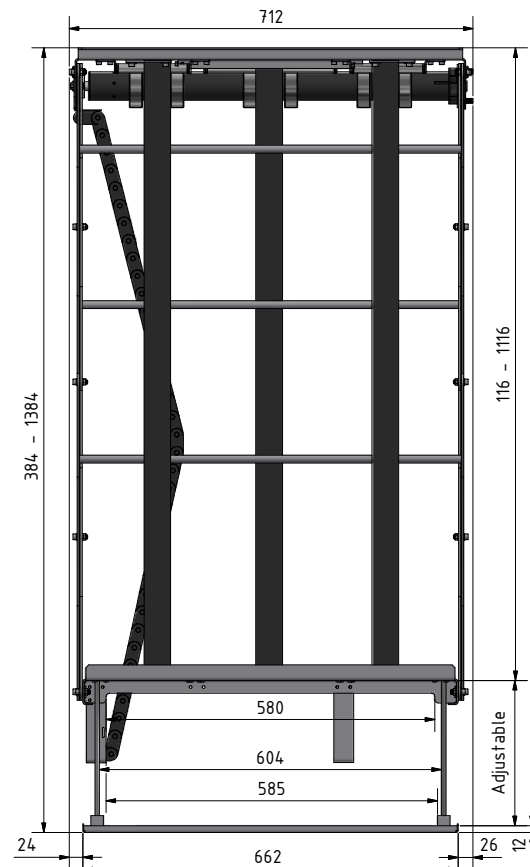

CATEGORY	PROJECTOR CEILING LIFT	DRAWING TYPE	
MODEL	PLCV5.4HD+XD500	DRAFT	FINAL
FEATURE A	NET VERTICAL MOTION UP TO 1000mm, MAX.LOAD 45kg	x	
FEATURE B	POWDER COATING IN RAL9005 BLACK BUFF	REVERSION	DATE
DRAWING No	V1.1.21062022-CA	NO	



ALL RIGHTS STRICTLY RESERVED. REPRODUCTION OR ISSUE TO THIRD PARTIES IN ANY FORM WHATSOEVER, IS NOT PERMITTED WITHOUT WRITTEN AUTHORITY FROM UNITECH SYSTEMS.